

成品示意图 360° VIEW PICTUR



光明皇帝
IMPERIAL ARMOR
YM-N011-SGBRD



组装基本步骤示意图
BASIC ASSEMBLING STEPS

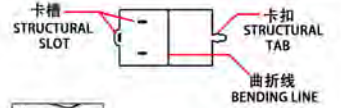

固定方式一:
将卡扣穿过对应固定孔,
按对应角度曲折 (图一)
Fitting method 1:
put the tab in the slot,
bend properly(p1)



固定方式二:
将卡扣穿过对应固定孔,
用钳子类工具垂直扭曲固
定卡扣 (图二)
Fitting method 2:
put the tab in the slot,
bend the tab vertically
with plier(p2).



- 注意细节 ATTENTION TO DETAIL
- 优先拼装 FIRST TO ASSEMBLY
- 非纹理面 Non textured surface

注意拼装前带手指套
Take finger cots before assembly

金属部件A METAL SHEET-A

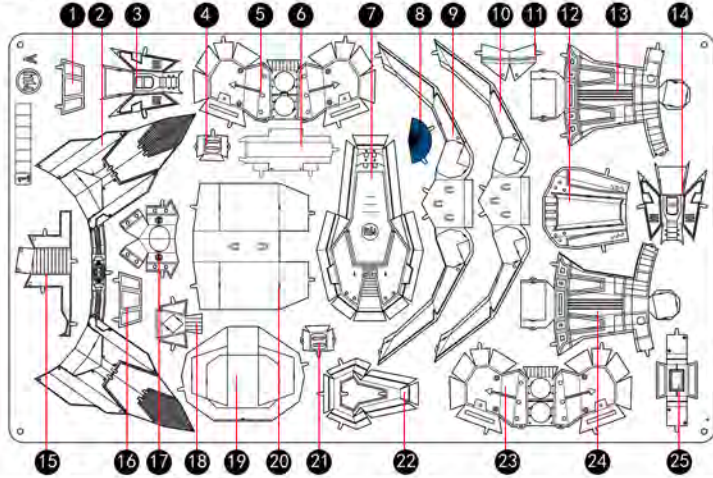

金属部件B METAL SHEET-B

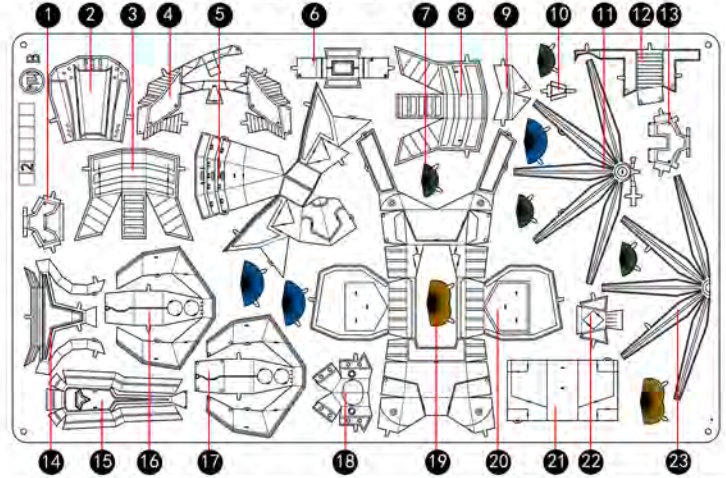

金属部件C METAL SHEET-C

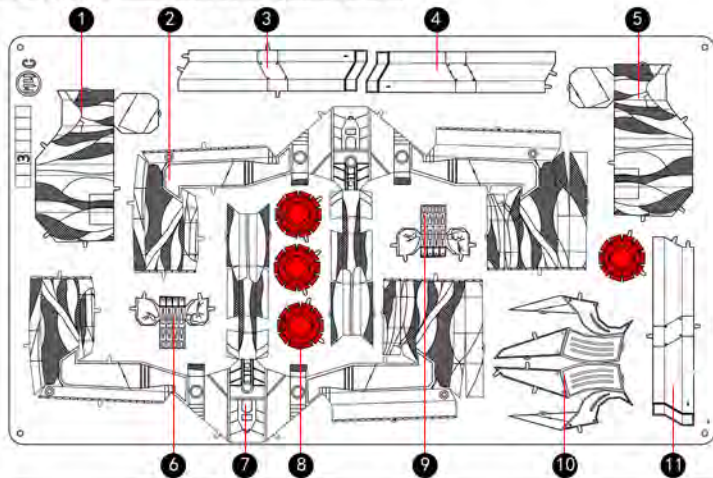

金属部件D/E/F/G METAL SHEET-D/E/F/G

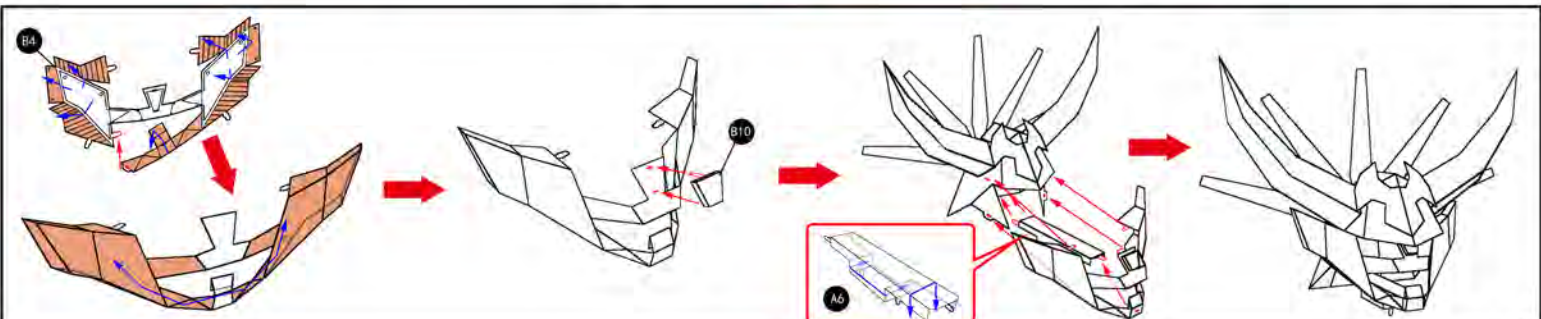
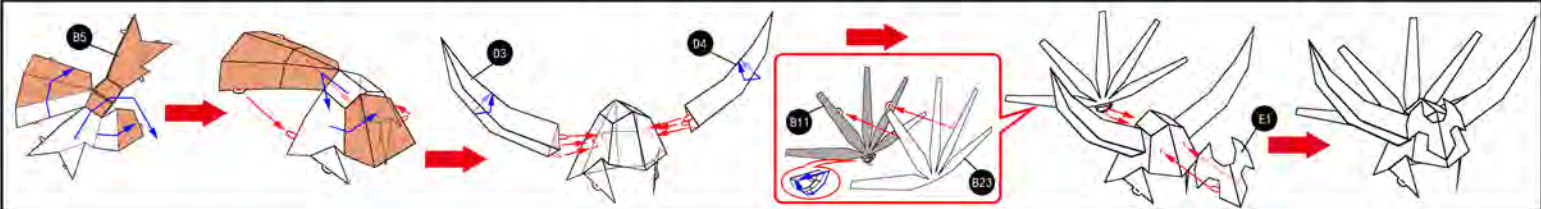
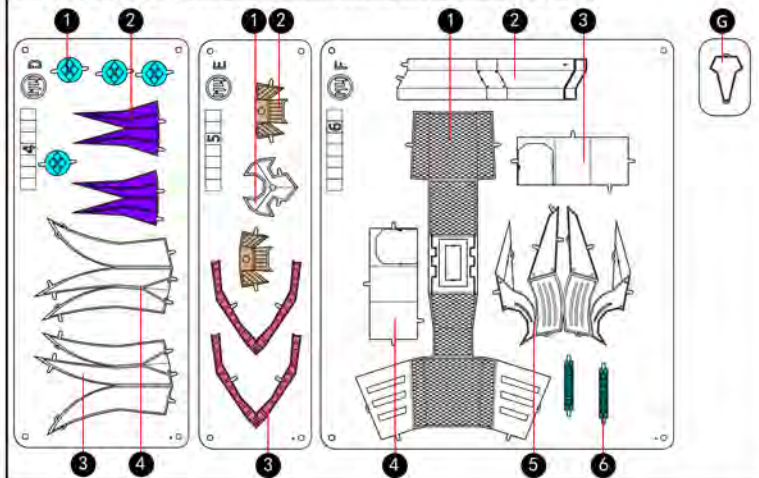

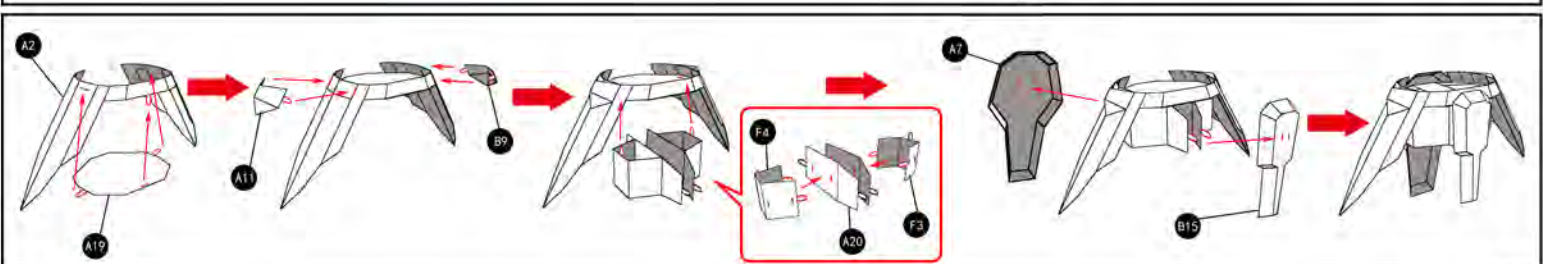
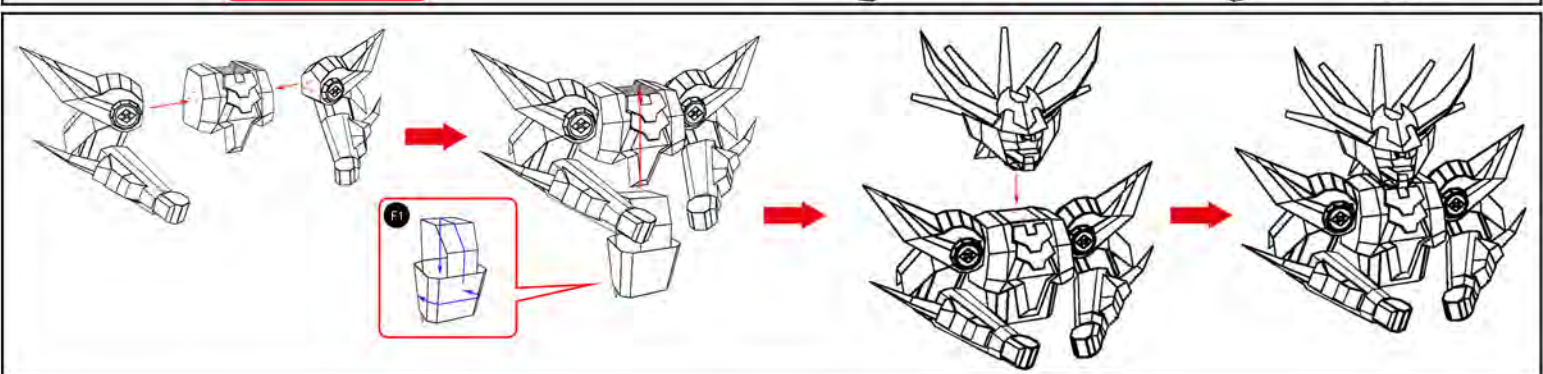
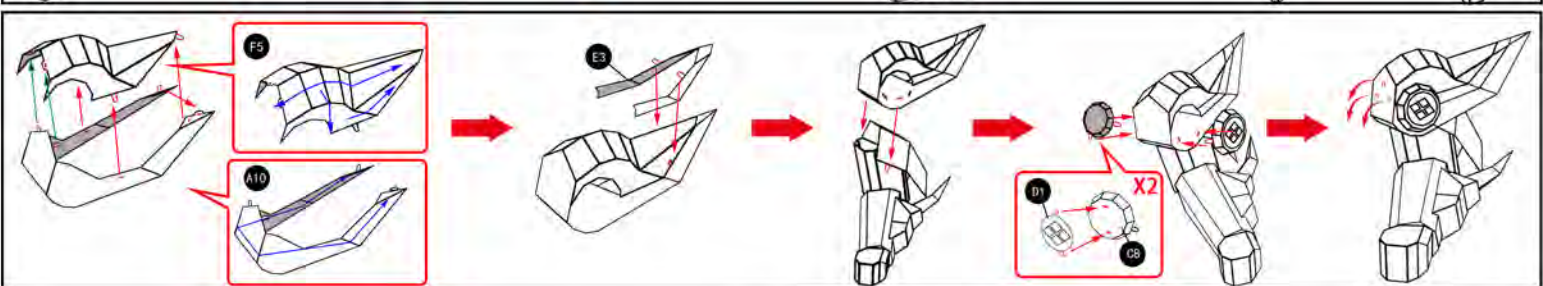
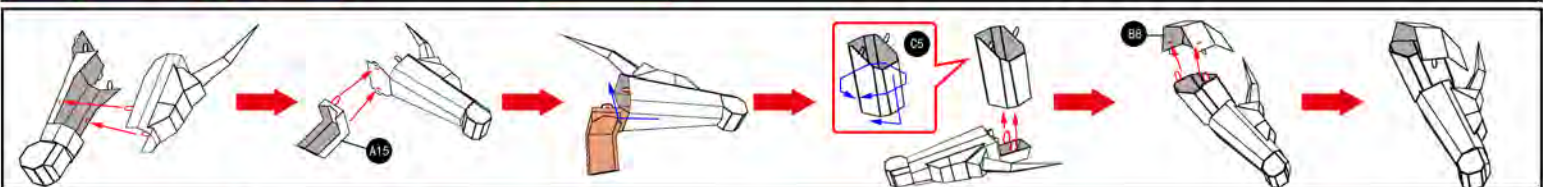
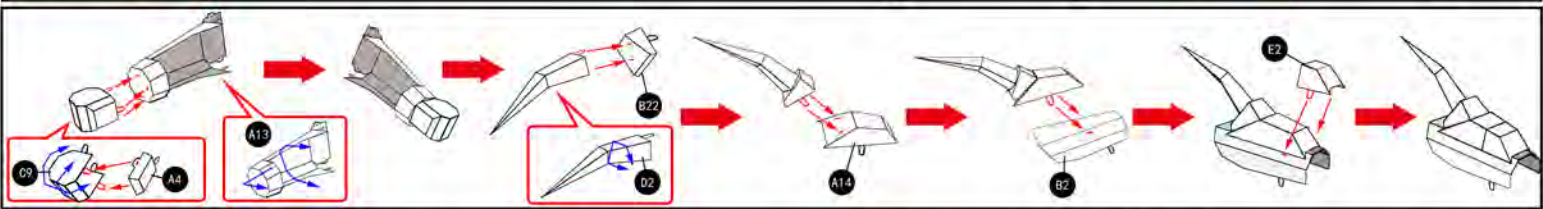
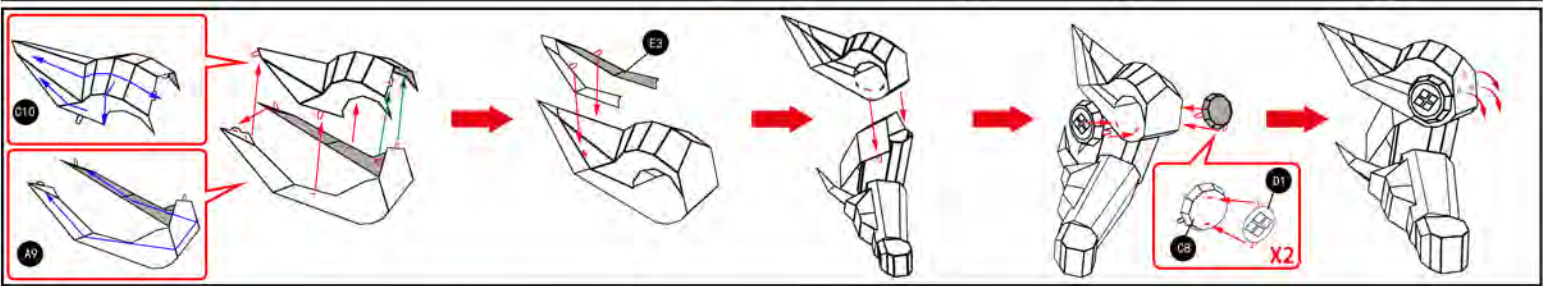
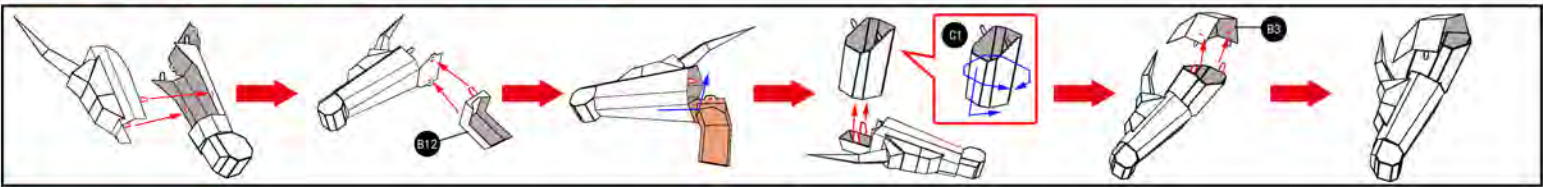
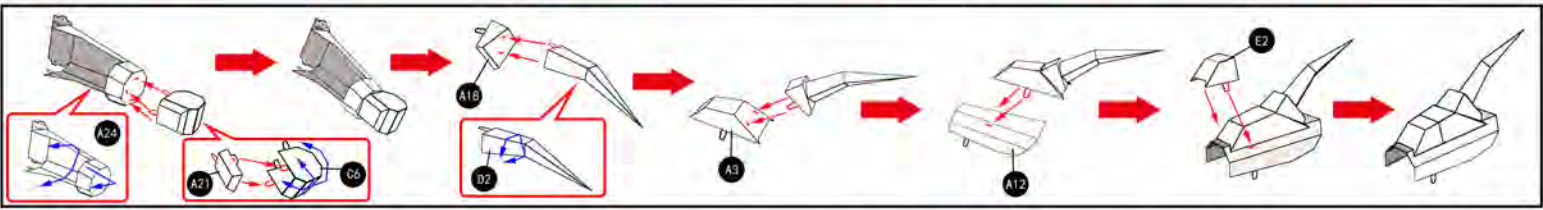
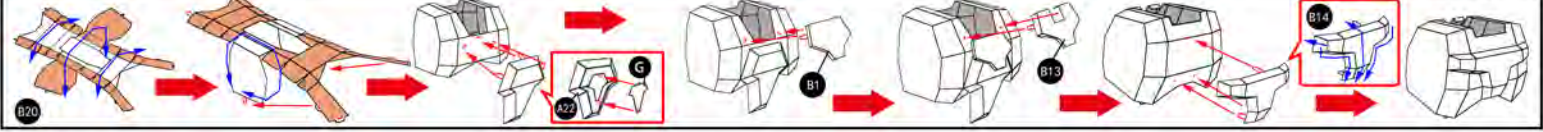

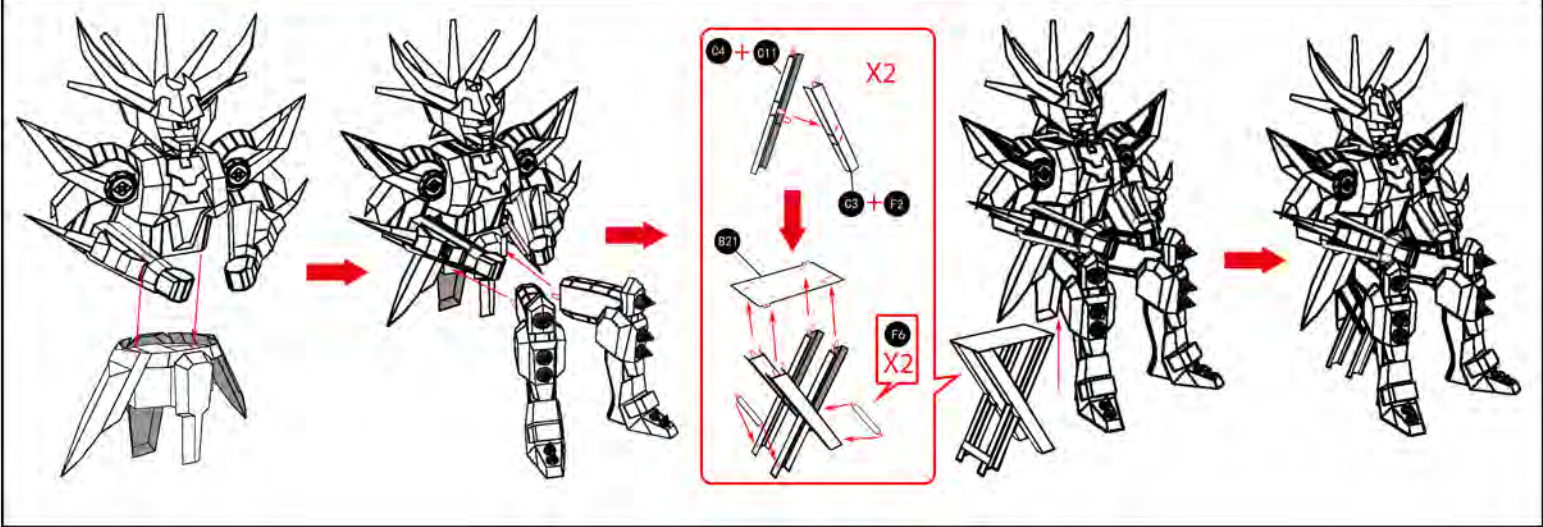
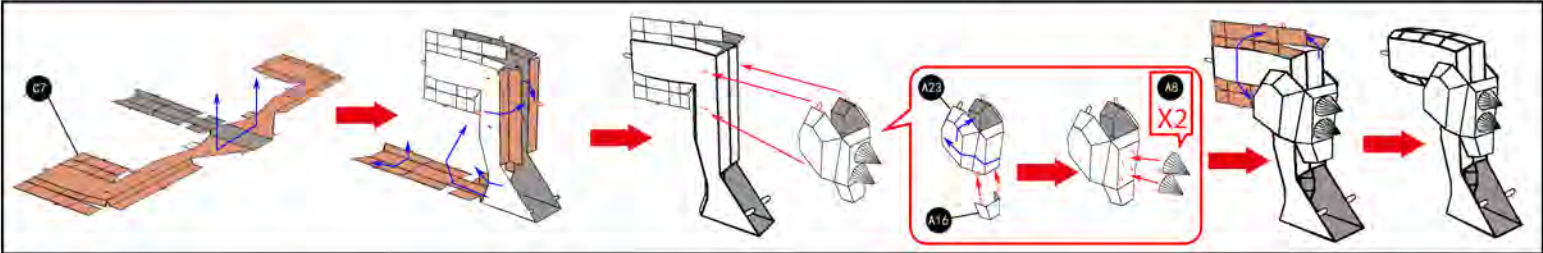
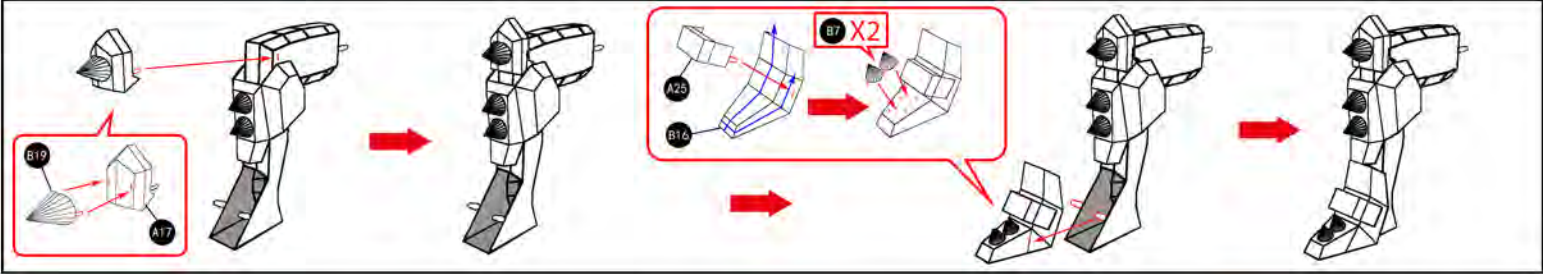
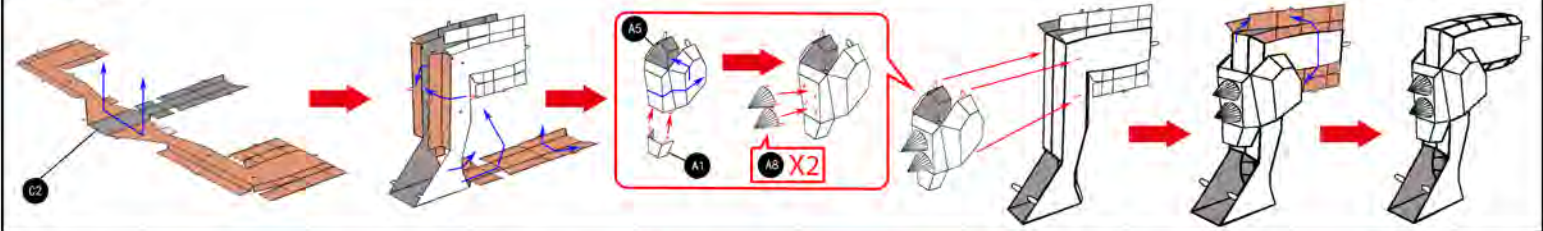

MU 艺模
MU art model

Tel: 021-58942999
Website: www.maplemu.com

扫码加入微信公众号 解锁更多模型
Scan the two-dimensional code to join us and unlock more models.

Design by: Clarence
因幡Tewi
EterNaL



上海艺模电子科技有限公司
Shanghai Art Model Electronic
Science and Technology Co., Ltd.

关注我们
focus on us